

Hands Assembly Instructions

Thank you for purchasing a quality timepiece from Infinity Instruments. To ensure the best protection for your precious timepiece, we have shipped your clock unassembled.

Parts included with your package in the box marked 'Parts'

- 1- Hour Hand (a) – Qty: 2
- 2- Minute Hand (b) – Qty: 2
- 3- Fixation nut (c) – Qty: 1

To assemble your timepiece, please follow the steps in the instructions below;

Step 1 - Unpack the protective packaging carefully and lay the clock down on a level surface.

Step 2 – Take the minute hand (longer hand) and set on movement shaft. Gently position the hand to the 12 o'clock position. Take the minute hand off the shaft.

Step 3 - Take the hour hand (the shorter hand) and make sure that it points to the 12 o'clock position. Press gently around the hand center so that it is securely sits onto the shaft.

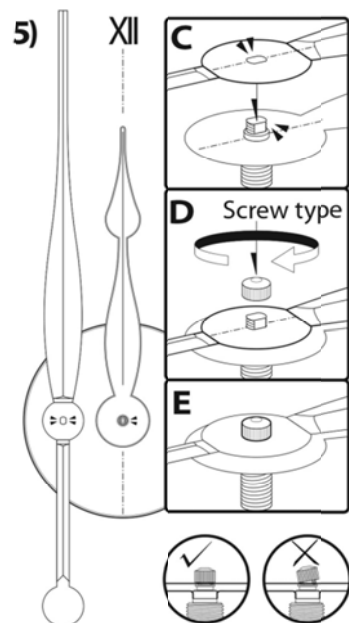

Step 4 - Take the minute hand (the longer hand), making sure that the opening at the hand center matches the rectangular shape of the shaft (Diagram C) and the hand points to the 12 o'clock position as well, gently press down .

Then, screw on the fixation nut and make sure that it is tightened (Diagrams D & E).

- Please make sure that the hands and fixation are assembled as per drawing (Diagram F).

Step 5 - Insert one 'C' alkaline battery into the clock movement and make sure of the correct polarity (+ -). Insert the (+) positive end first and press the (-)

negative end.

Step 6 - Set the correct time using hand set knob located on the rear of the movement. Hang your new clock at desired location making sure that you are using strong enough hardware to support your precious timepiece.

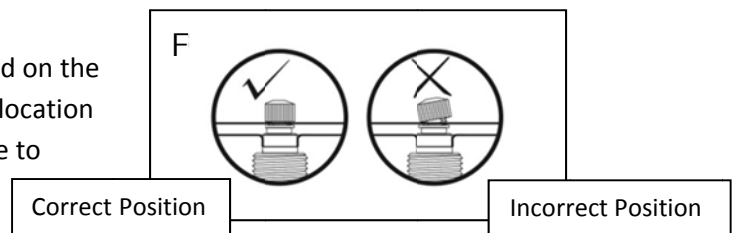
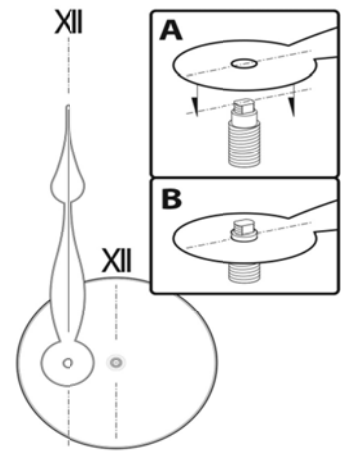

If there are any questions during the assembly process, please contact us at fixmyclock@infinityinstruments.com.